

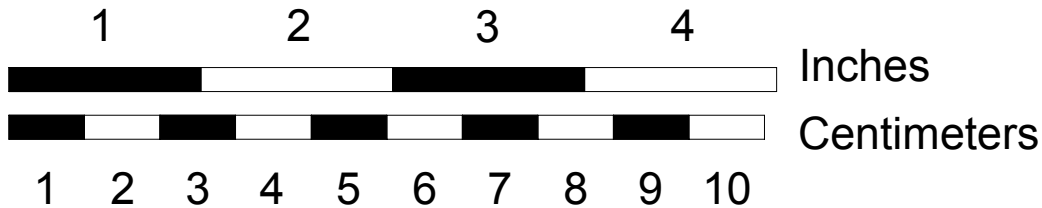

Mighty Mini FT-22

Beta v.4

Original Plans By: Josh Bixler
Modified for MM Pod By: LocalFiend



SPECS:

DESCRIPTION	IMPERIAL	METRIC
Length	18.25 in	464 mm
Center of Gravity	9.3 in	236 mm
Wing Span	18 in	457 mm
Wing Area	146 in ²	9.4 dm ²
Dry Weight	4.5 oz	130 g
All Up Weight	7 oz	200 g
Wing Loading	6.9 oz/ft ²	21.1 g/dm ²
Wing Cube Loading	6.9	

RECCOMENDED SETTINGS (Use Low Rates for F pack power level motors)

	THROW HI	LOW	EXPO
Elevator	35°	25°	35-55%
Rudder	35°	25°	35-55%

RECCOMENDED ELECTRONICS:

Motor	2204 2300kv - or F Power Pack
ESC	12 Amp
Prop	6045
Servos	2x 5 gram
Battery	800-1500mAh 2s-3s

Firewall / Control Horns
1/16" (1.5mm) Thick
Hobby Grade Plywood

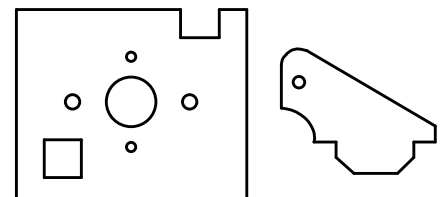

FOLD TYPES



A Fold - (Above)



B Fold - (Beside)



C Fold - (Cover)

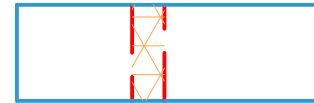

LINE TYPE / COLOR

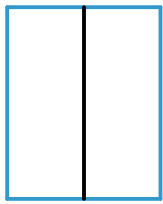

Cut

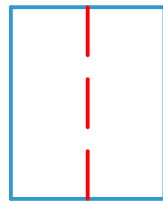

50% Score



Crease

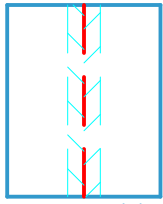

45° Double Bevel

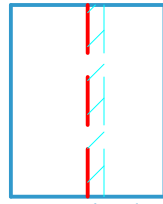

45° Single Bevel

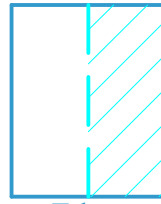

Edge Bevel

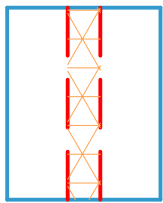

Cavity

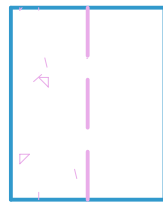

Remove Paper

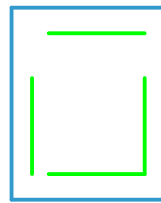

Reference /Optional



SYMBOLS

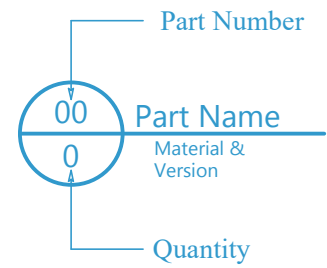

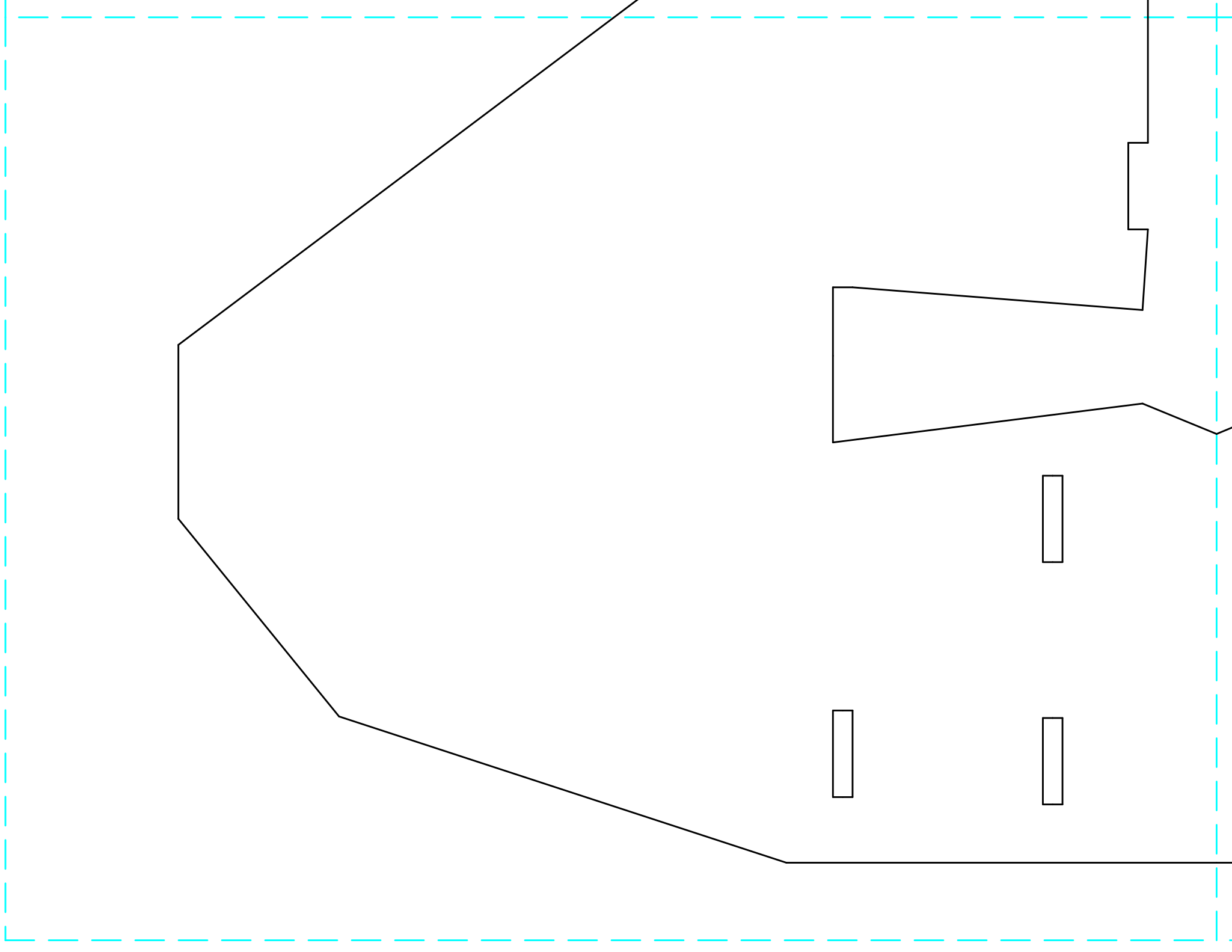

01 Wing
1
Foam Board
MM FT-22 Beta v.4



04 Bottom Support
1 Foam Board
MM FT-22 Beta v.4

09 Pod Support
1 Foam Board
MM FT-22 Beta v.4

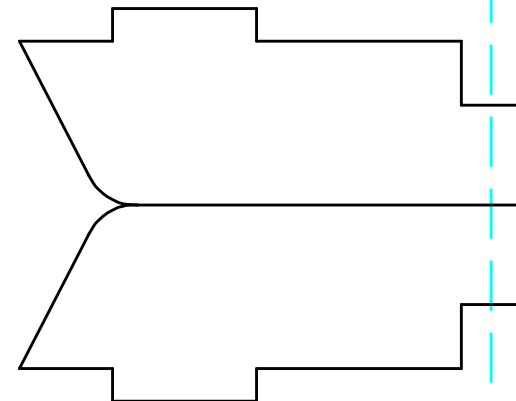

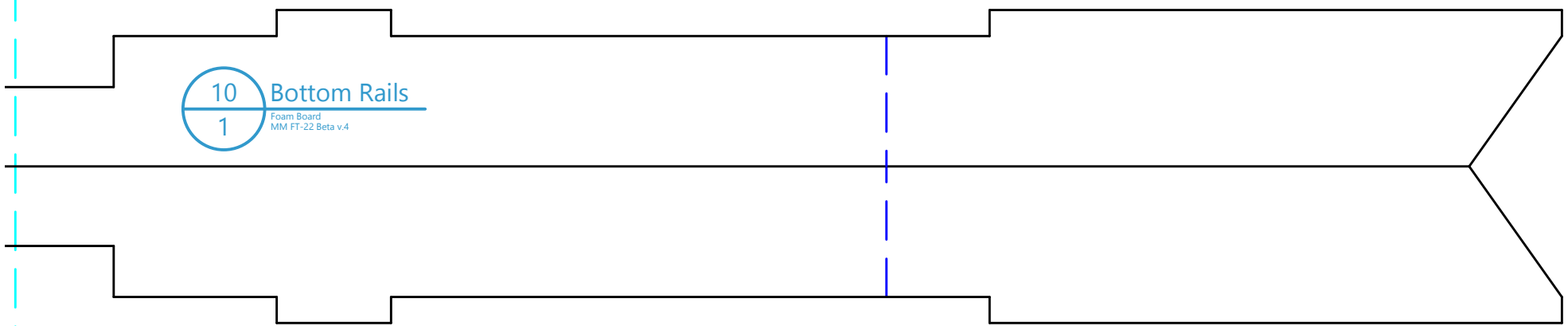
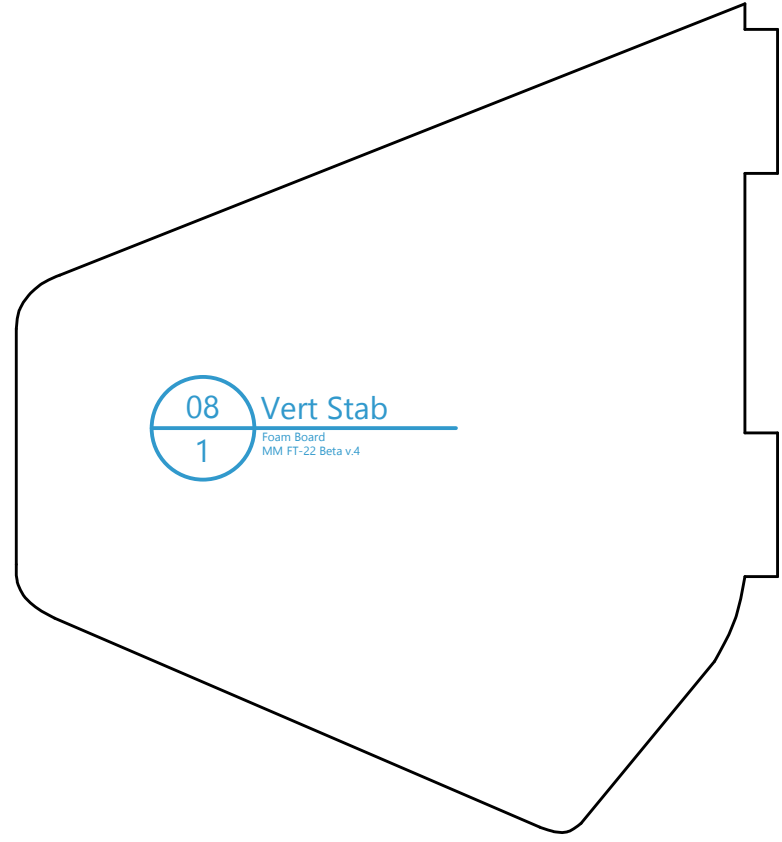
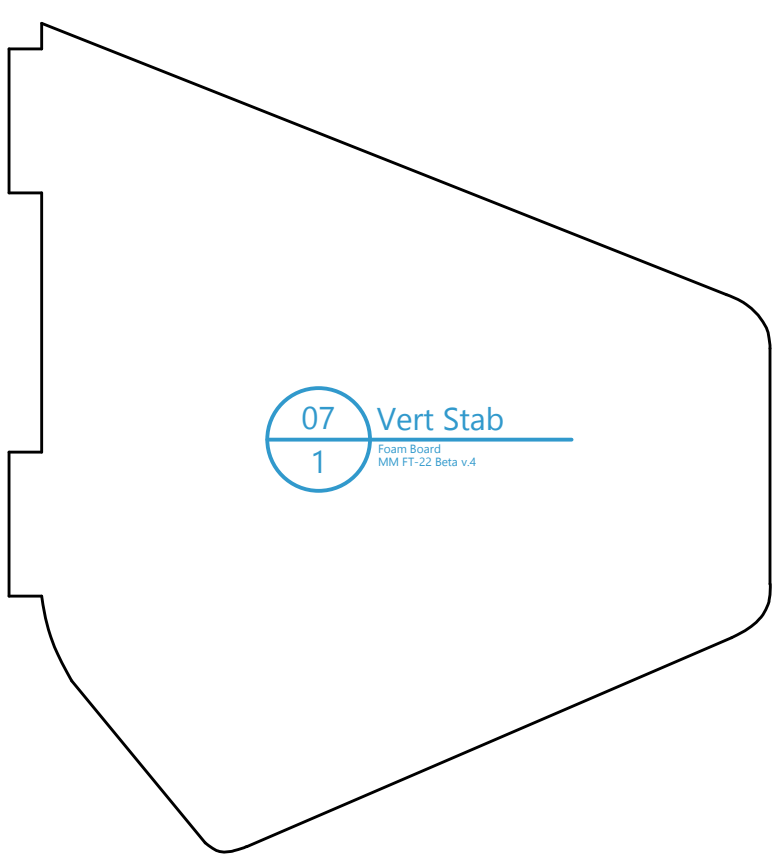

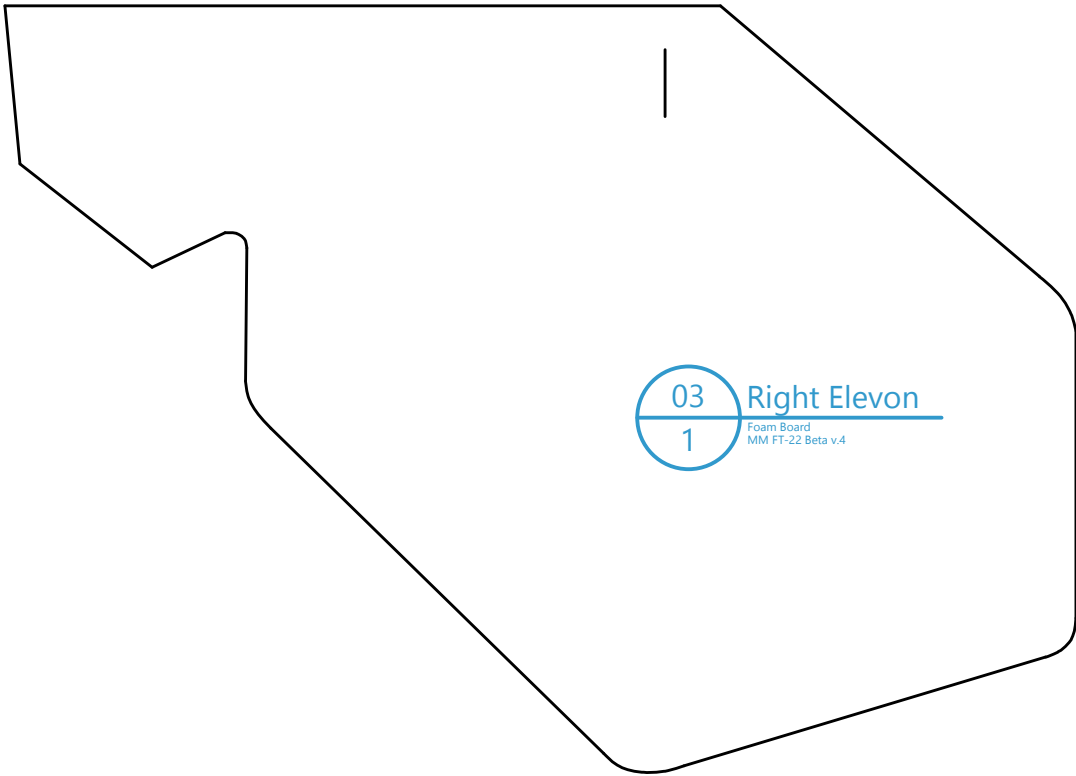

03 Right Elevon
1
Foam Board
MM FT-22 Beta v.4

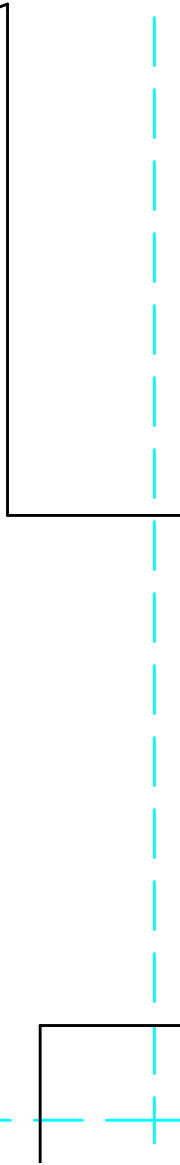
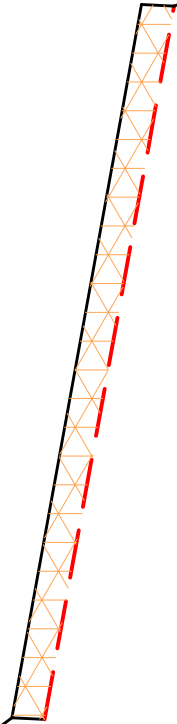

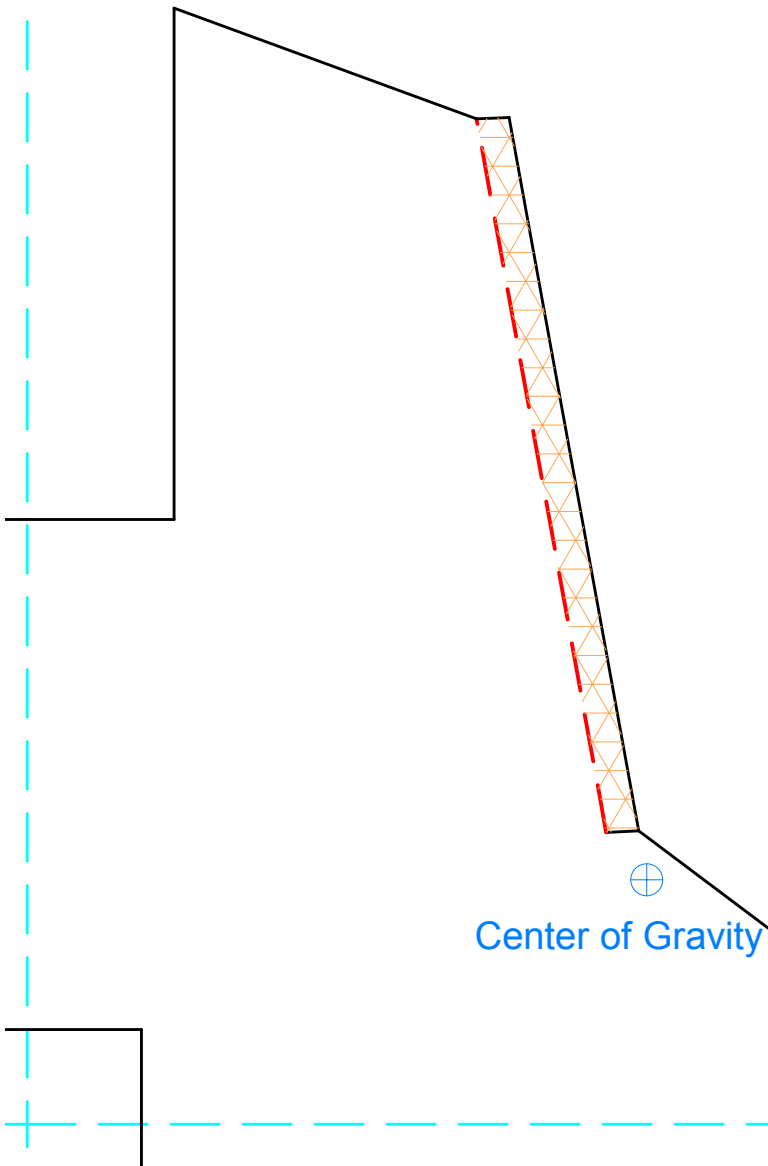
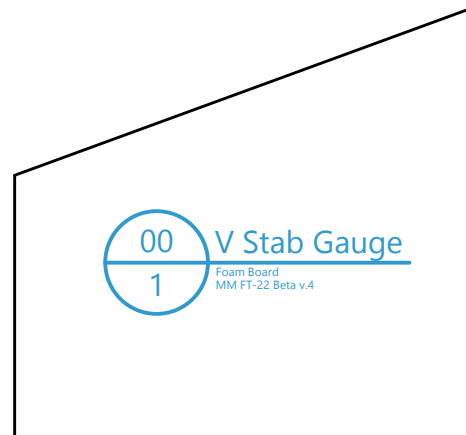
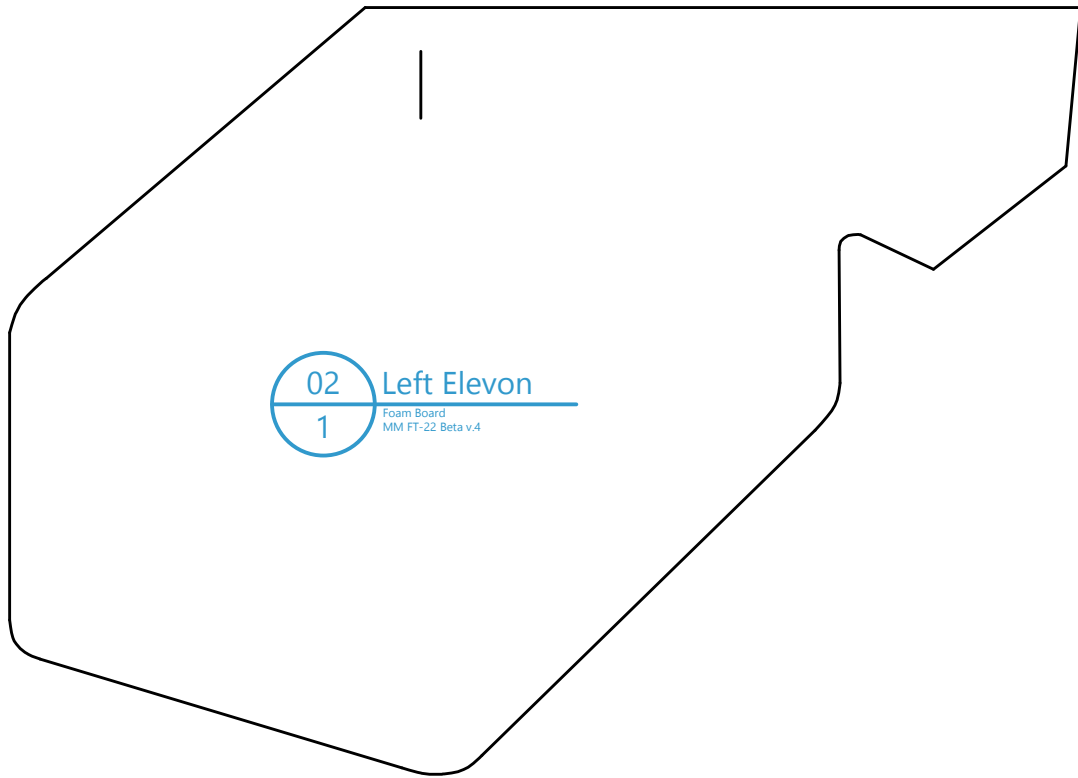

00
1

Power Pod

Foam Board
MM FT-22 Beta v.4



06
1

Hatch

Foam Board
MM FT-22 Beta v.4

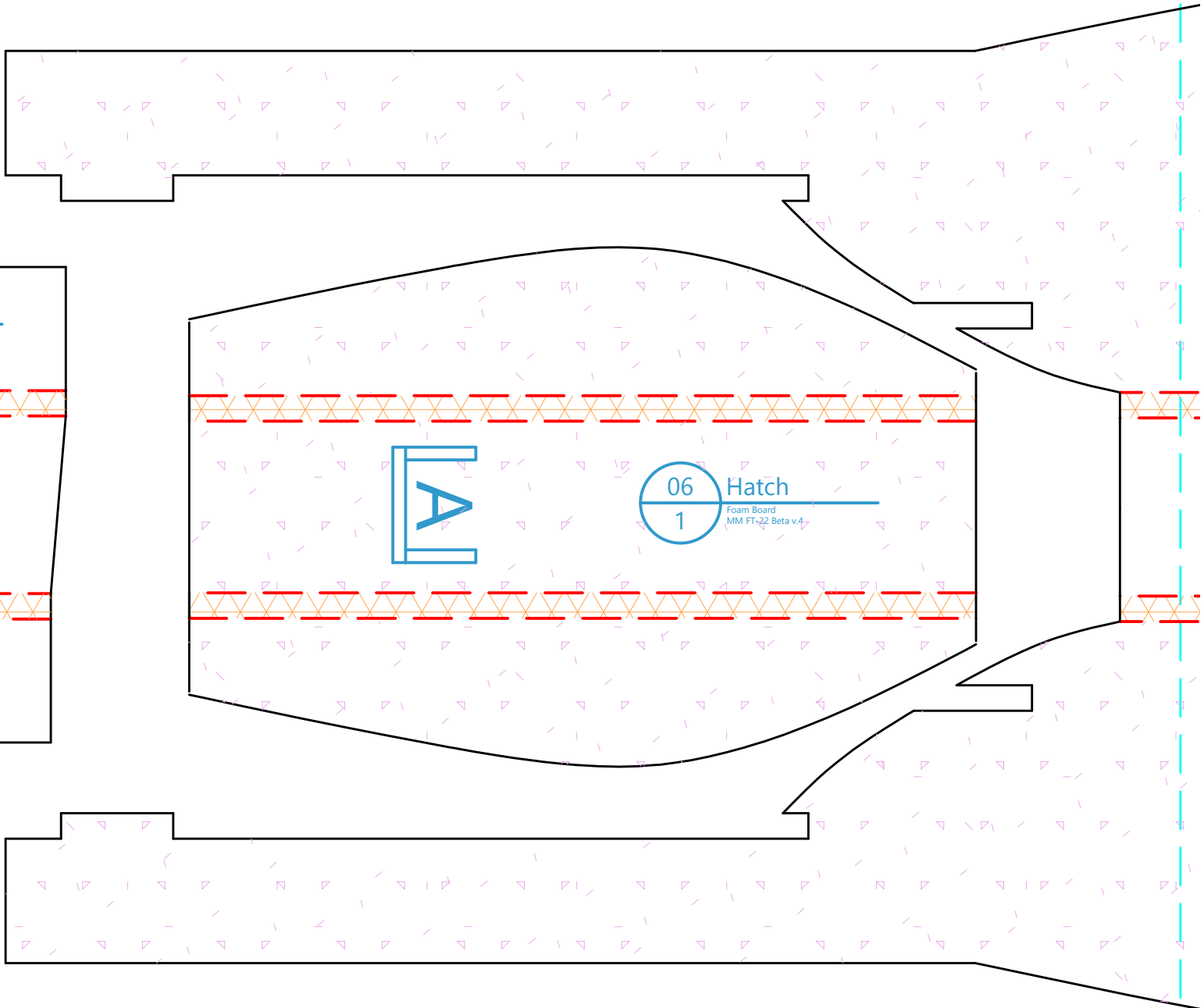
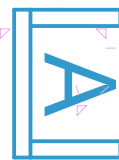

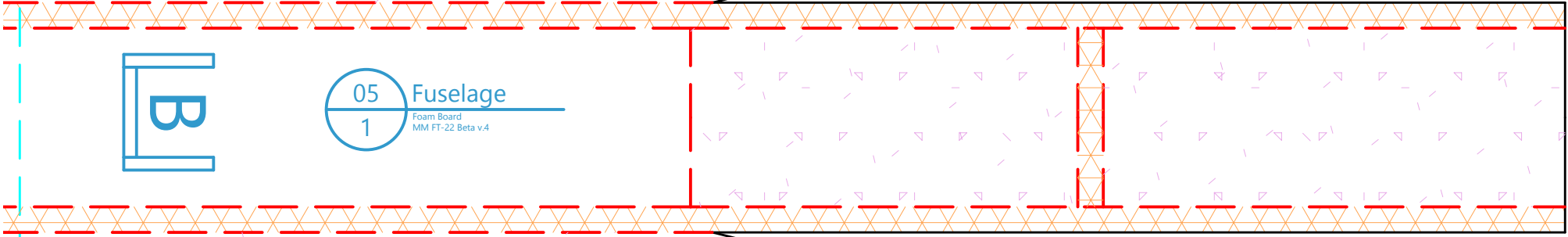
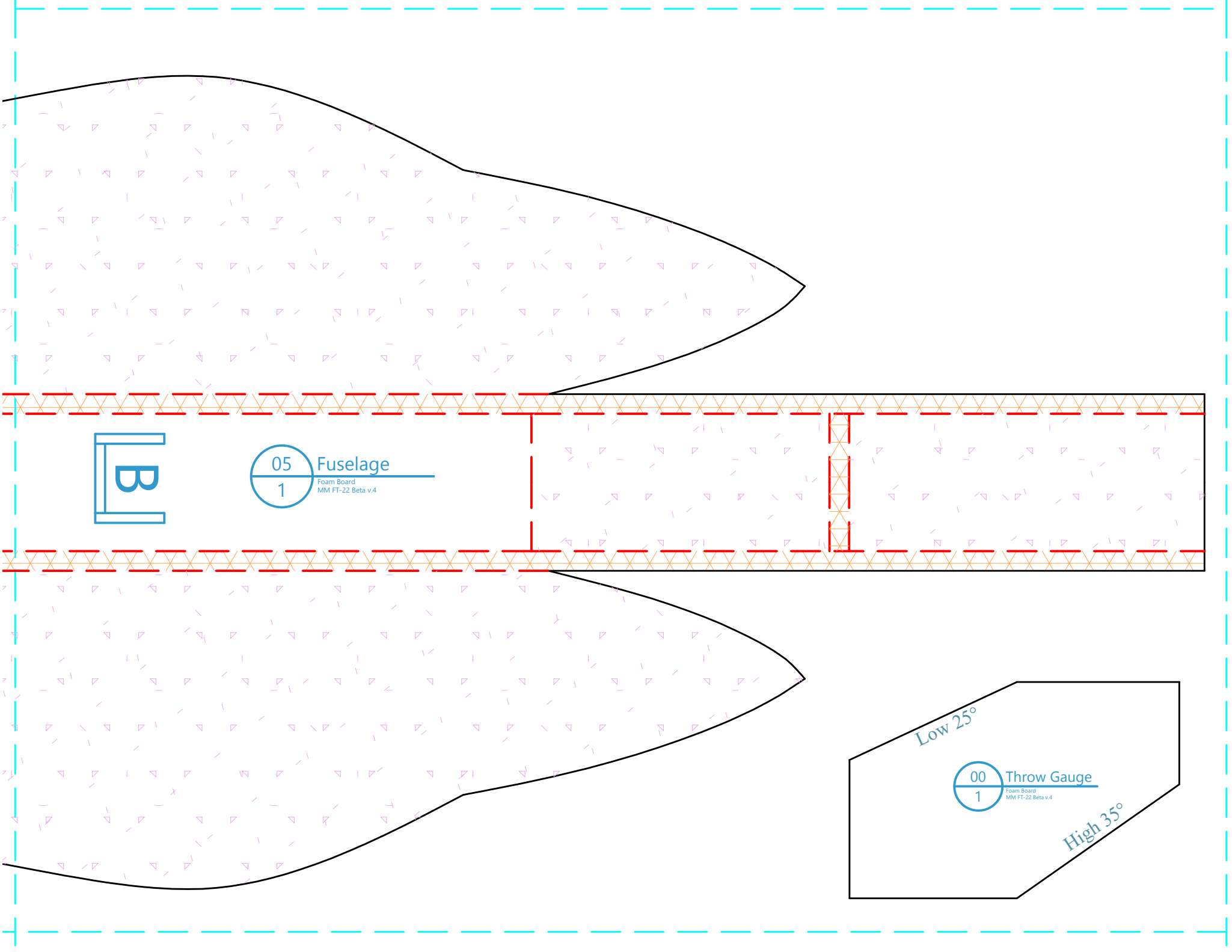

B

05 Fuselage
Foam Board
1 MM FT-22 Beta v.4

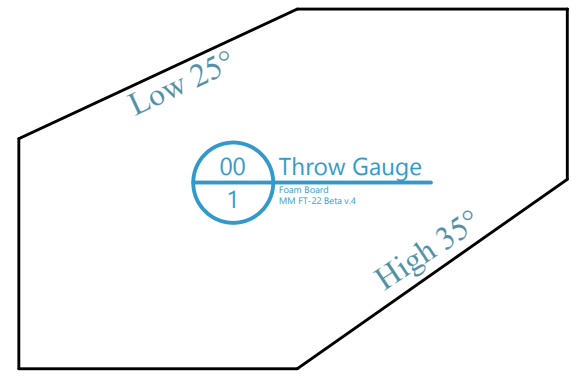

00 Throw Gauge
Foam Board
1 MM FT-22 Beta v.4

11
1

Hatch Cover

Poster Board
MM FT-22 Beta v.3

12
1

Pod Cover

Poster Board
MM FT-22 Beta v.3

